

# Thermal Circuit Breaker W28



F0214-A

## Features

- Approved to international standards (push to reset type)
- Labor-saving snap-in mounting
- tested to EN 60934



Technical data of approved types on request

## Electrical data

Calibration	will continuously carry 100% of rating	
0.25...2 A models:	may trip at 101...174%, but must trip at 175% of rating within one hour at +25°C	
3...16 A models:	may trip at 101...134%, but must trip at 135% of rating within one hour at +25°C	
Maximum operating voltage	32 Vdc; 250 Vac 50/60 Hz	
Interrupt capacity	1000 A at 250 Vac, 50/60 Hz; 32 Vdc in accordance with UL 1077	
Resettable overload capacity		
0.25...2 A models:	6x rated current	
3...16 A models:	10x rated current	
Reset time		
0.25...2 A models:	max 180 s	
3...16 A models:	110...60 s	
Dielectric strength	1500 Vrms	

## Typical resistance vs. current rating

Current rating	Typical resistance	Current rating	Typical resistance	Current rating	Typical resistance
A	Ω	A	Ω	A	Ω
0.25	14.0	5.0	0.030	12.0	0.009
0.50	3.55	6.0	0.026	13.0	0.009
0.75	2.0	7.0	0.017	14.0	0.007
1.0	0.89	8.0	0.016	15.0	0.007
2.0	0.17	9.0	0.014	16.0	0.007
3.0	0.069	10.0	0.011		
4.0	0.043	11.0	0.010	Data for ambient temperature +25°C	

## Time vs. current trip curve

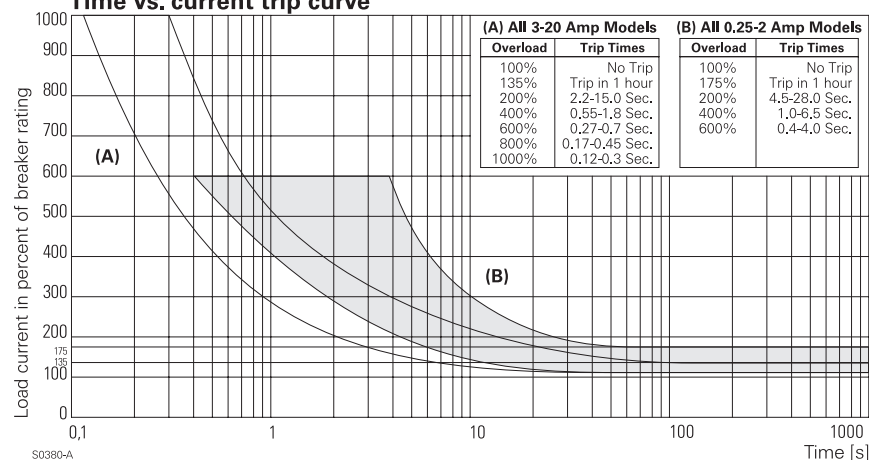

## Ambient compensation chart

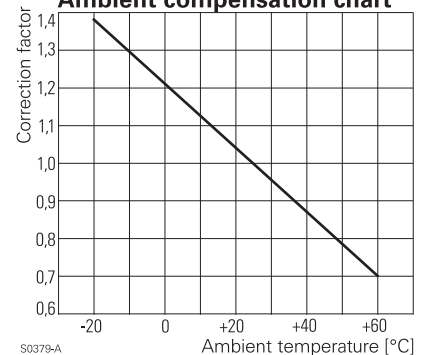

How to use the correction: Multiply the breaker rating by correction factor to determine the compensated rating. Calculate the overloads in terms of the compensated rating to use the published trip curve.

# Thermal Circuit Breaker W28

## Other data

Ambient temperature	-20...+60°C
Terminals	6.35mm (.250") quick connects soldering to terminals not recommended
Mounting	snaps into panel from front
Weight	10 g
Packaging unit	100 pcs.

## Dimensions

Dimensions in mm

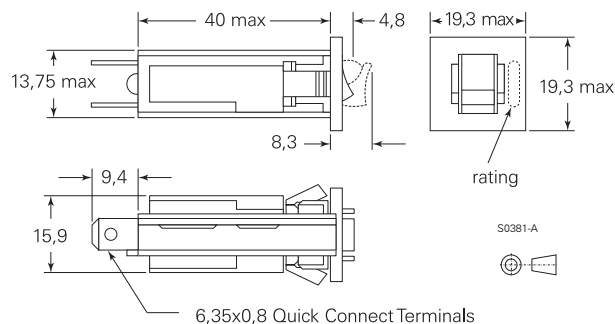

## Recommended panel cutouts

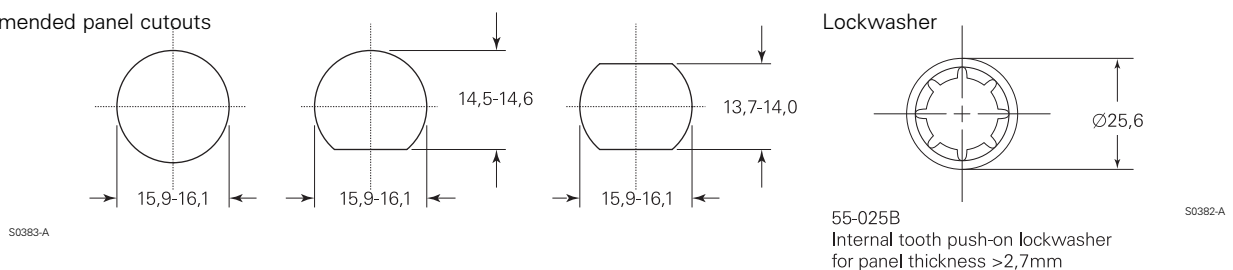

## Product key

**W 2 8** - **X** **1** **A** -

Type

Circuit function

**X** series trip, push-to-reset button

Terminal type and mounting

**Q** **6,35mm Quick Connect for panel thickness 0.8...1.6mm**

**T** 6,35mm Quick Connect for panel thickness 1.9...2.7mm  
for panels other than above, order "Q" type and 55-025B internal  
tooth push-on lockwasher

Front color

**1** black with white rating marking

Button color

**A** black

Current rating

**0.25, 1, 2, 3, 6, 8, 10, 12, 15, 16**

Preferred types in bold print. Other types on request.

Product key	Function	Terminals	Version	Current rating	Part number
W28-XQ1A-0.25	thermal	6.35mm	black	0.25 A	1-1393250-9
W28-XQ1A-1	circuit breaker	Quick Connect	white marking	1 A	2-1393250-3
W28-XQ1A-2	series trip			2 A	3-1393250-2
W28-XQ1A-3	push-to-reset			3 A	3-1393250-4
W28-XQ1A-6				6 A	3-1393250-9
W28-XQ1A-8				8 A	4-1393250-1
W28-XQ1A-10				10 A	2-1393250-5
W28-XQ1A-12				12 A	2-1393250-7
W28-XQ1A-15				15 A	3-1393250-0
W28-XQ1A-16				16 A	3-1393250-1